

# Roberts County, SD

County Seat Sisseton, SD

<b>T-129-N</b>	Norway Pages 68-69	Minnesota Pages 66-67	Lien Pages 60-61	Victor Pages 82-83	White Rock "W" Pages 86-87	White Rock "E" Pages 84-85
<b>T-128-N</b>						
<b>T-127-N</b>	Bossio Pages 26-27	Enterprise Pages 34-35	Hart Pages 52-53	Harmon "W" Pages 46-47	Harmon "E" Pages 44-45	
<b>T-126-N</b>	Long Hollow Pages 64-65	Sisseton Pages 74-75	Grant Pages 42-43	Bryant Pages 28-29		
<b>T-125-N</b>	Dry Wood Lake Pages 30-31	Goodwill Pages 40-41	Easter Pages 32-33			
<b>T-124-N</b>	One Road Pages 70-71	Agency Pages 20-21	Lawrence Pages 66-67	Bocker Pages 24-25		
<b>T-123-N</b>	Alto Pages 22-23	Spring Grove Pages 73-75	Lee Pages 58-59	Lake Pages 54-55		
<b>T-122-N</b>	Ortley Pages 72-73	Summit Pages 60-61	Springdale Pages 76-77	Garfield Pages 36-37	Genesee Pages 38-39	Lockwood Pages 62-63
	<b>R-52-W</b>	<b>R-51-W</b>	<b>R-50-W</b>	<b>R-49-W</b>	<b>R-48-W</b>	<b>R-47-W</b>



# STAVICK ELECTRIC & HEATING

Commercial  
&  
Residential  
Wiring



Coleman Furnaces  
Heat Pumps  
Air Conditioning

**Jesse Stavick**

Phone: 605-268-3584

Home: 605-698-4930

Fax: 605-698-4059

111 1st Ave. W.

Sisseton, SD

T-126-N

SISSETON PLAT

R-51-W

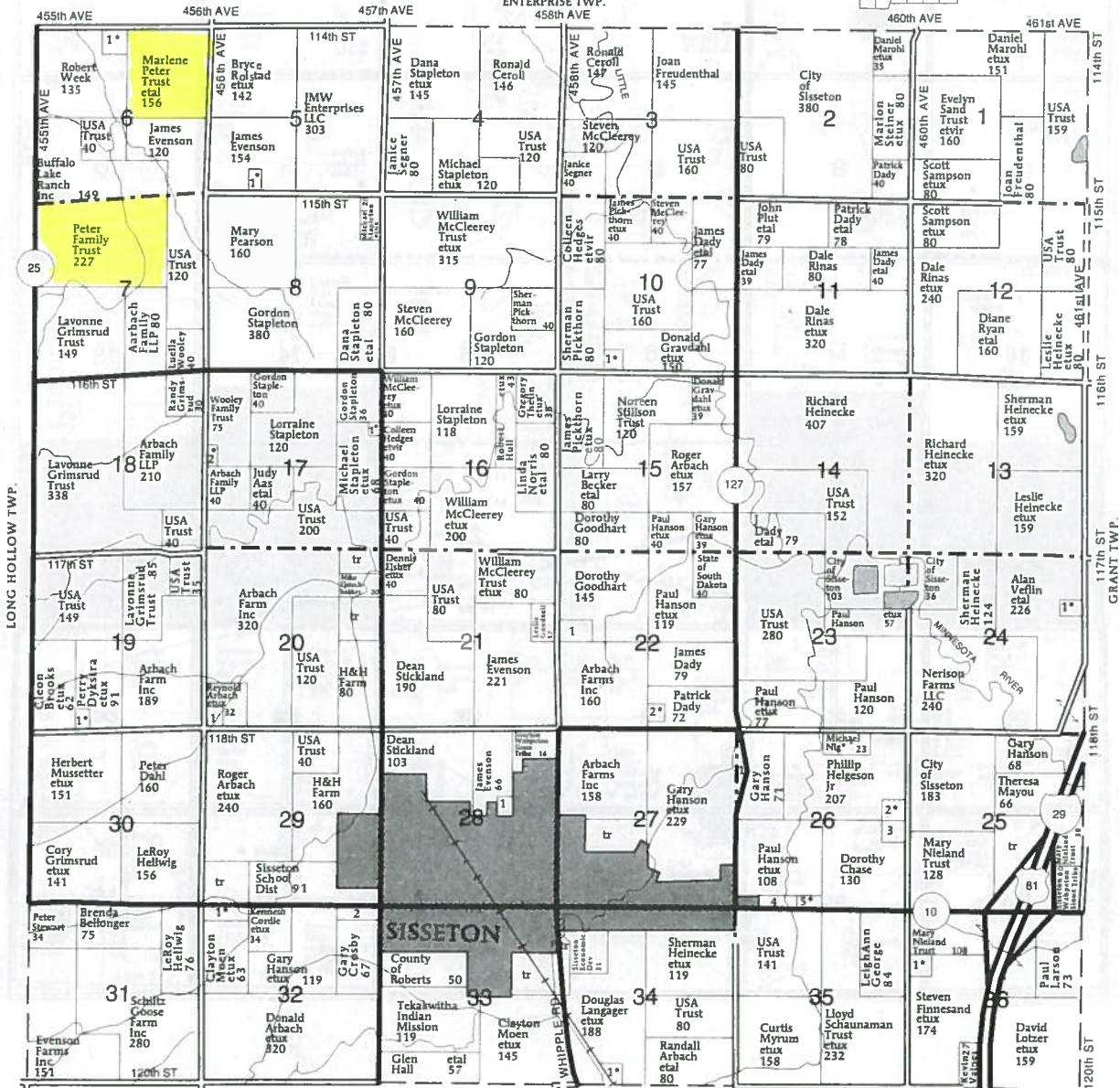

- SISSETON TOWNSHIP**
- SECTION 5**  
1. Larson, Kevin 6
- SECTION 6**  
1. Richards, Darold 14
- SECTION 10**  
1. Gravdahl, Paul 7

- SECTION 17**  
1. Agnew, John 6  
2. Aas, Calvin 5
- SECTION 19**  
1. Holman, James 9
- SECTION 20**  
1. Stickland, Bill 8

- SECTION 22**  
1. Hill, Gwen 15  
2. Dady, Patrick 8
- SECTION 24**  
1. Veflin, Douglas 8

- SECTION 26**  
1. State of South Dakota 9  
2. Vaines, Gary 11  
3. Whetstone Valley Greenhouse Inc 10  
4. Martenson, Carol 14

5. Martenson, Douglas 6
- SECTION 28**  
1. USA 7
- SECTION 32**  
1. Olson, Kenneth 11  
2. County of Roberts 11

- SECTION 34**  
1. Knutson, Gaylord 9
- SECTION 36**  
1. Greseth, Edwin 10



Who Wants Yesterday's News?  
 Don't forget to bundle up your newspapers  
 weekly for easy recycling!

T-127-N

BOSSKO PLAT

R-52-W

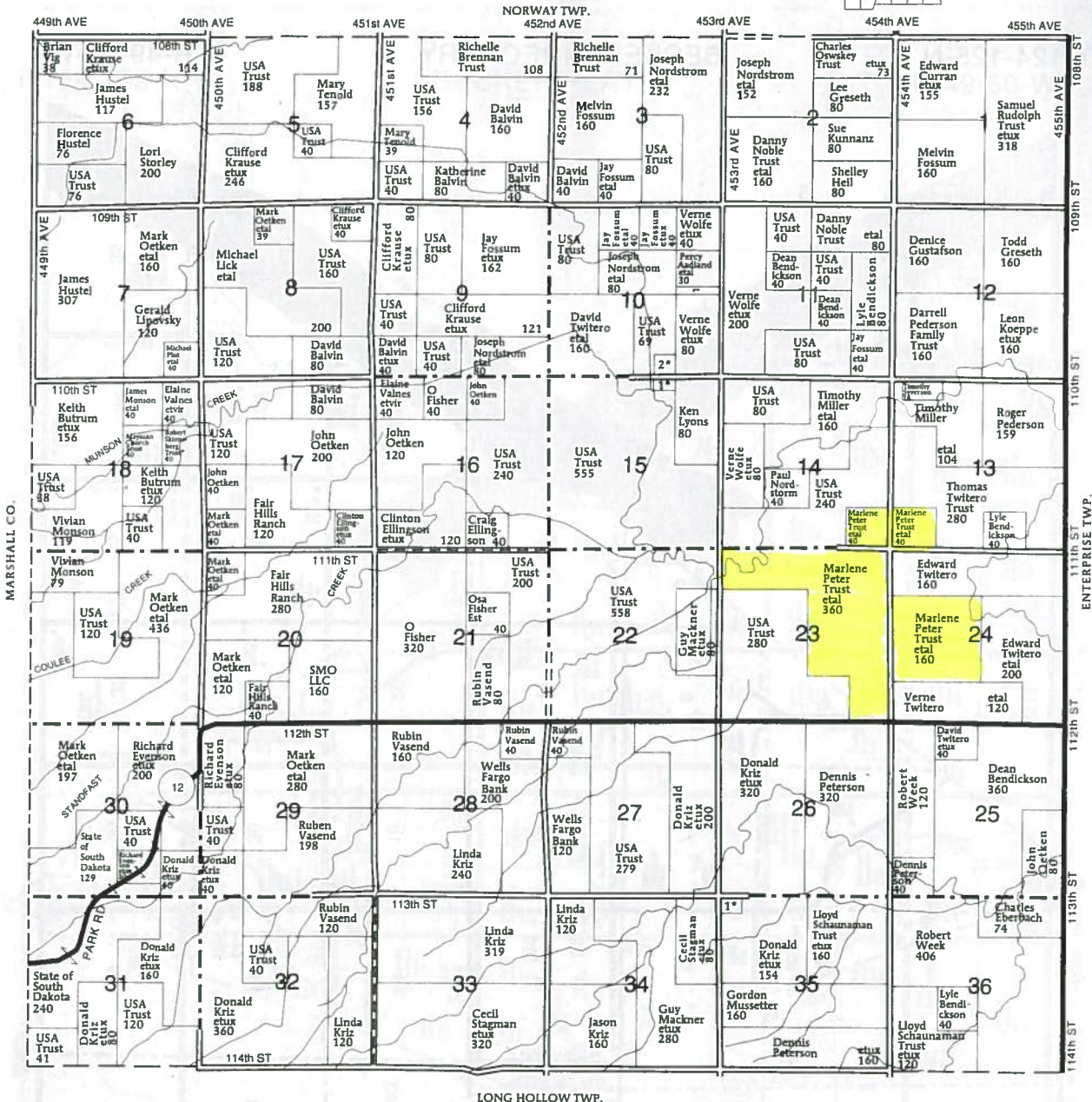

- BOSSKO TOWNSHIP**  
**SECTION 10**  
 1. Aadland Family Trust 10  
 2. Whitecloud, Annie 11  
**SECTION 15**  
 1. Whitecloud, Annie 5  
**SECTION 35**  
 1. Kriz, James 6